

NOTE:

1. OUTSIDE CORNERS MAY ALSO BE FIELD FABRICATED USING UNREINFORCED MEMBRANE.
2. BEGIN INSTALLING FASTENER PLATES 6" FROM CORNER. KEEP FASTENERS APPROX. 6" FROM HORIZONTAL AND VERTICAL APPLICATIONS.
3. FLASHINGS MAY BE ADHERED OR INSTALLED DRY, REFER TO SPECIFICATIONS.
4. APPLY RE-FLEX CUT EDGE SEALANT TO ALL FIELD CUT REINFORCED MEMBRANE EDGES.

ALTERNATE WALL/CURB ATTACHMENT

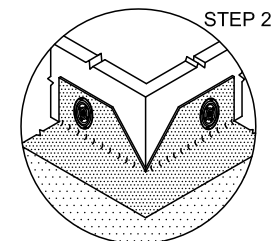
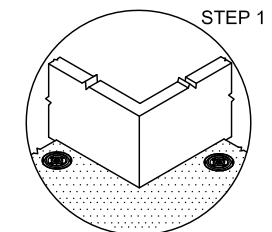

OUTSIDE CORNER PREFORMED FLASHING DETAIL

ACCEPTABLE WITH RE-FLEX TPO
MECHANICALLY ATTACHED SYSTEMS

PROJECT:

SCALE

NOT TO SCALE

Revision Date: 5-10-2015

#327

RPI
Roofing Products International, Inc.